

This map is not to scale!

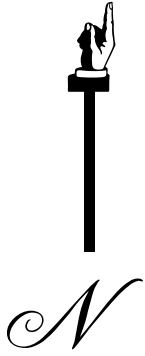

Spring Hill Community Farm

545 1 1/2 Avenue
Prairie Farm, Wisconsin
54762 (715) 455-1319

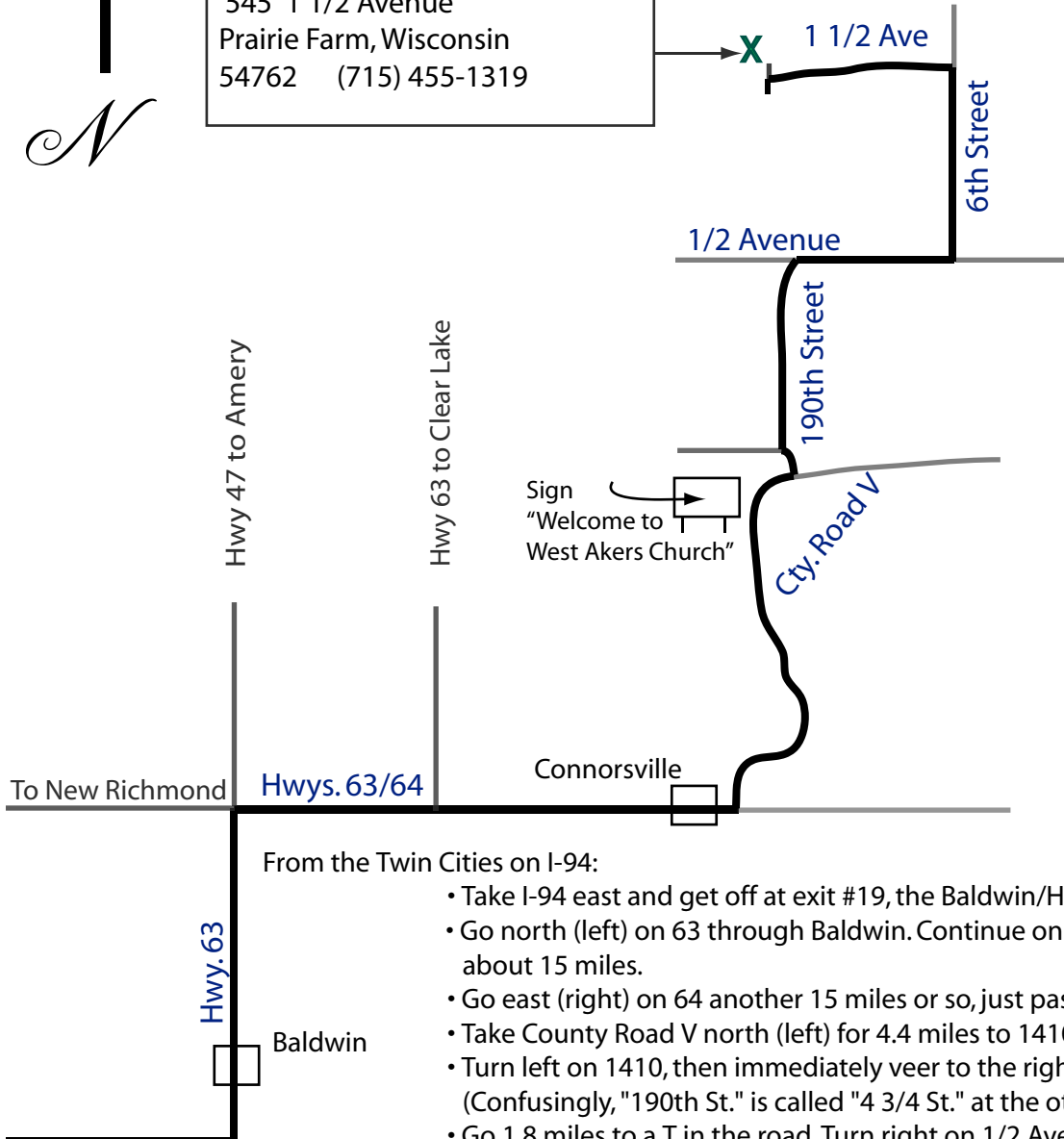

From the Twin Cities on I-94:

- Take I-94 east and get off at exit #19, the Baldwin/Hwy. 63 exit.
- Go north (left) on 63 through Baldwin. Continue on 63 to Hwy. 64, about 15 miles.
- Go east (right) on 64 another 15 miles or so, just past Connorsville.
- Take County Road V north (left) for 4.4 miles to 1410.
- Turn left on 1410, then immediately veer to the right on 190th St. (Confusingly, "190th St." is called "4 3/4 St." at the other end.)
- Go 1.8 miles to a T in the road. Turn right on 1/2 Ave.
- Go 1.2 miles on 1/2 Ave. to 6th St.
- Turn north (left) on 6th St. and drive .7 mile to 1 1/2 Ave.
- Turn west (left) onto 1 1/2 Ave.
- Spring Hill Community Farm is the last (fourth) place on the road.

I 94 to Mpls/St. Paul